

Doeve Brokers

yachts & ships



Doeve Brokers/Valuars vof
Sworn & EMCI Certificated Brokers
& Valuors S&P Yachts & Ships

Westhavenkade 87c
NL-3133 AV Vlaardingen

Phone +31 (0)10 248 98 30
Mobile +31 (0)653 20 20 84

E-mail info@doevemakelaar.nl
Website www.doevemakelaar.nl
www.doeve.be
www.doeve.fr

IBAN NL82 INGB 0664 0466 73
CoC Rotterdam 24266857
VAT NL8214.04.520.B01



Dutch Clipper 26.53 with TRIWV

€ 99.500,--

reduced in price

VAT not applicable

Dimensions (m)	26.53 x 4.50 x 1.20	Ref. no.	200101
Mooring	Near Nevers, France	Year	1895
Price information	reduced in price	Material	steel

Vision Doeve Brokers

Former inland cargo ship that has been completely refurbished into a spacious cruising Live Aboard barge with a large sun deck. Inside there is a spacious salon with a spacious U-kitchen. Because of the upperpart of the hold is raised there is a lot of headroom inside. The barge will be sold with a renewed Dutch TRIWV certificate (ES-TRIN) so that you as a buyer do not have to renew it for the next 7 years (counted from the inspection date). From bow to stern the layout is as follows: forepeak, bulkhead, owner's cabin with French bed, SB: guest cabin with double bed, PS: bathroom with bath and shower, salon with open kitchen, PS: corridor with on SB the toilet area, stairs to the wheelhouse with side doors. With a wheelhouse that can be removed, the cruising area is very large and makes her a very suitable vessel for navigating European inland waterways, including the French canals and rivers.

General information

Yard:	Shipyard Joh. van Duijvendijk BV, NL-Krimpen aan den IJssel
Hull shape:	flatbottom
Hull material:	iron/steel
Deck material:	steel
Superstructure material:	steel
Construction method:	hardwooden top side of the wheelhouse riveted new steel is welded bulwark around rubbing strake around 2 watertight bulkhead(s) raised upperpart hold
Steering system:	mechanical wheel 2x steel rudder
Windows:	plastic window frames double glazing portholes wood window frames single glass
Displacement (approx.):	67,691 m3
Ballast (approx.):	22 ton concrete blocks
Airdraft (approx.):	3,35 m 2,45 m with dismantled wheelhouse
Owner:	British owner
Registration:	Dutch registered B-registered Costs for the change of ownership and / eventually deletion are for purchasers amount.
Colour / Paint System:	black hull green bulwark 08-2023 cream superstructure 08-2023 last underwatership treatment 2014
Certificates:	inland waterways certificated (TRIWW / ES-TRIN) zone 2 Netherlands zone 3 zone 4 valid until: 08-2027
Suitable for / as:	suitable as a year round live- aboard recreational vessel
General information:	For sale due to health issues.
Additional information:	Hull shape is suitable for drying out. forepeak with chain locker Great vessel for cruising on the European canals and rivers. Great vessel for cruising on the French canals and rivers.

Technical information

Enginepower:	150 Hp 110 kW
Engine brand:	Scania Vabis
Revolutions:	2400 RPM
Engine model:	TD 642
Number of cylinders:	6
Construction year engine:	1956
Running hours (approx.):	15000 as declared
Fuel:	diesel
Fuel tank (approx.):	380 litre white 150 litre red 2 steel tank(s)
Cooling system:	closed cooling pipes dry exhaust
Propulsion:	3 blade propeller greased lubrication of propeller shaft
Gearbox:	Twin Disc mechanical reduction/ratio 3:1
Speed (approx.):	6 km/hour cruising speed at 700 RPM 12 km/hour top speed
Heating:	stove on diesel & electric
Air conditioning:	present
Electricity system:	12 / 24 / 230 Volt 230 Volt shore power connection
Batteries:	2x 200 Ah batteries 1x 120 Ah starter batterie(s) generator
Battery charger:	Victron Multiplus Compact combi inverter/charger 24/2000/50 Mastervolt Charge Master battery charger 24/30-3 Hellas battery charger 24/80
Battery isolator:	present
Earth-leakage breaker:	present
Genny:	Lister diesel @1800 RPM 15 kVA 230 Volt 500 running hours (approx.)
Inverter:	Victron Multiplus Compact combi inverter/charger 24/2400/50 inverter 24/3000
Solar panels:	2x present
Fresh water tank (approx.):	1800 litre 2 steel tank(s)
Water pressure system:	hydrophore pump
Hot water system:	boiler/water calorifier (230 Volt) 150 litre
Holding tank (approx.):	present not yet in use
Diesel waterseparator:	present
Bilge pump:	electric pump & by engine

	2x manual pump
Gas system:	yes, bottle(s) in bottle box
Additional information:	partly LED lightning

Accommodation

Interior:	various materials have been used oak floor(s) suitable for living on board see photographs
Insulation:	Rockwool Isover PU plates
Cabins:	2 cabins
Berth:	owners cabin: 1x 2-pers = French bed Guest cabin(s): 1x 2-pers
Lay-out plan (not to scale):	see attachment
Bathroom:	bath with shower hot & cold running water washbasin with hot & cold running water in 1 area together with the toilet
Toilet / Heads:	Forward: electric toilet Aft: flush toilet
Galley:	U-shape galley
Cooker:	5-burner hob on gas cookerhood stainless steel
Oven:	gas oven grill
Microwave:	present
Fridge / Refrigerator:	present 230 Volt
Freezer:	present 230 Volt
Worktop:	oak wooden worktop
Washbasin:	stainless steel sink
Water tap:	mixer tap with hot & cold running water
Entertainment:	2x flatscreen TV satellite antenna DVD-player radio/CD player
Headroom (approx.):	ownerscabin (approx.) 2,29 m guest cabin (approx.) 2,50 m bathroom / toilet in the front (approx.) 2,50 m salon (approx.) 2,50 m galley (approx.) 2,50 m corridor / walkthrough (approx.) 1,83 m

	wheelhouse (approx.) 1,94 m
Additional information:	useful as live-aboard
	inventory
	washing machine

Navigation equipment

Navigation equipment:	Icom IC-M323 VHF
	& portable VHF
	horn
	window wiper
	blue board

Rigging and sails

Mast:	lantern mast
	wood
Lowerable:	yes
	manual

Equipment

Anchor equipment:	manual anchor winch
	Klipp anchor
	in hawse-hole
	40 m anchor chain
	specified length(s) is/are approximate
Outdoor cushions:	present
Boarding ladder:	present
Davits:	steel
Safety:	fire blanket
	fire extinguishers
	life buoy
	life jackets
	according to the certification requirements
Additional information:	set deck furniture
	aluminium gangway

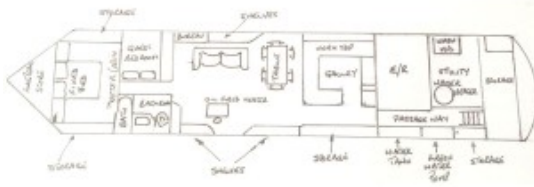











59

